



***Public Works Committee Meeting Agenda
Monday, September 11, 2023, 5:30 p.m.
Fillmore Conference Room – Thurber Building***

1. City Engineer – Craig Britton:
 - A. West Chatfield Drainage Improvement Update Pay App #1
 - B. 2023 Street Improvement Project Update & Pay App. #2
 - C. Enterprise Drive Berm Update
 - D. Hwy 74 Traffic Study Update
2. Public Works Director – Brian Burkholder
 - A. Retaining Wall Proposal – Avenue B



City of Chatfield

Thurber Community Center • Chatfield Municipal Building
21 Second Street Southeast • Chatfield, Minnesota 55923 • 507-867-3810
www.ci.chatfield.mn.us

MEMORANDUM

TO: PUBLIC WORKS COMMITTEE
FROM: CRAIG BRITTON
SUBJECT: WEST CHATFIELD DRAINAGE IMPROVEMENT PROJECT – PAY REQUEST NO. 1
DATE: SEPTEMBER 6, 2023
CC: CITY ADMINISTRATOR, MICHELE PETERSON
SUPERINTENDENT OF CITY SERVICES, BRIAN BURKHOLDER

Action Requested: Recommend payment of pay application number 1 in the amount of \$106,153.00. Payment includes work performed on the West Chatfield Drainage Improvement Project including removals, the installation of the storm sewer and structures, seeding and restoration of the disturbed areas of construction along with the reshaping of the drainage swale along the east side of Hill Street. Payment also includes work outside of the West Chatfield project that involved extending a culvert that is located on top of Hill Street.

Background: Pearson Backhoe started work on the drainage improvement project in late July and substantially completed the project in the middle of August. Remaining work includes patching the bituminous pavement and final clean up. Most of the project went as planned, however, as they were installing the storm sewer up Hill Street, they encountered rock excavation for approximately 60 ft. Pearson also dug around additional utility lines which took them additional time to install the storm sewer and removed some additional pavement that was in bad shape. Since Pearson was working in the West Chatfield area, Brian asked them to extend a culvert, shape the drainage swale and place rip rap at the outlet of the culvert on the top of Hill Street. That work was included on the attached invoice but will be paid out of the Storm Sewer Fund. The original contract amount for the West Chatfield project was \$105,995 and with the additional work (rock excavation, utilities and additional patching) I'm anticipating the project will be approximately \$7,500 over the original contract amount.

Please let me know if you have any questions.

Thanks,

Craig Britton

PEARSON BACKHOE SERVICE INC
24330 Richland Rd.
St.Charles, MN 55972

Invoice

DATE	INVOICE #
8/15/2023	7393

BILL TO
City of Chatfield 21 2nd St SE Chatfield, MN 55923

P.O. NO.	TERMS
West Chatfield	Net 30

Date	ITEM	QUANTITY	DESCRIPTION	RATE	AMOUNT
8/15/2023	service	1	mobilization	3,000.00	3,000.00
	service	1	clearing and grubbing	2,500.00	2,500.00
	service	1	relocate mail box's	250.00	250.00
	service	1	remove culverts	1,500.00	1,500.00
	service	1	remove concrete drive	806.00	806.00
	service	1	remove bituminous pavement	2,140.00	2,140.00
	Dirt	1	30 yards of black dirt	1,050.00	1,050.00
	Rock	180	180 ton of class 5	24.00	4,320.00
	service	1	connect to existing manhole	1,500.00	1,500.00
	service	1	construct manholes 48"	12,800.00	12,800.00
	service	1	construct manholes 60"	9,000.00	9,000.00
	service	1	951ft. of 24" HDPE	49,452.00	49,452.00
	service	1	install biologs inplace of silt fence	615.00	615.00
	service	1	seeding, hydromulch and matting	6,070.00	6,070.00
	service	4	additional time for utility crossings, potholing and exposing, along Sunset Street & Hill Street	500.00	2,000.00
	service	5	additional time for hard rock removal, 80ft. x 6' x4' near M/H #5	500.00	2,500.00
	service	10	additional time for cleaning upper ditch , extending culvert and place riprap	500.00	5,000.00
	service	1	place Cat 50, seed and hydromulch upper ditch, 177 sq yards	1,200.00	1,200.00
	material	1	24' x 10' culvert with band	450.00	450.00
Thank you for your business.				Total	\$106,153.00

Additional Work on top of Hill Street - \$6,650
To be paid for by Storm Sewer Fund

WIDSETH

INVITATIONAL QUOTE
WEST CHATFIELD DRAINAGE IMPROVEMENTS
WIDSETH PROJECT NO. 2022-10196
CHATFIELD, MN

Rochester
3777 40th Avenue NW
Suite 200
Rochester MN 55901

507.292.8743
Rochester@Widseth.com
Widseth.com

Please return quote to the Chatfield City Hall by **THURSDAY, APRIL 7th, 2022 at 10:00 AM.**

The undersigned hereby proposes and agrees to furnish all the necessary labor, new materials, equipment, tools and services necessary for the construction of the project for the lump sum totals below. The estimated quantities provided below are approximate and include only the major construction items. The contractor shall perform their own quantity take-off and base their quote accordingly.

No.	Item	Estimated Qty	Unit
1	Mobilization	1	L.S. 3000
2	Clearing and Grubbing	1	L.S. 2500
3	Salvage and Reinstall Mailbox	1	Each 250
4	Remove Culvert	95	L.F. 1500
5	Remove Bituminous Pavement	214	S.Y. 2140
6	Remove Concrete Driveway Pavement	31	S.Y. 806
7	Topsoil Borrow	30	C.Y. 1050
8	Aggregate Base, Class 5 (10")	138	Ton 3312
9	Type SP 9.5 Wearing Course Mix (B) (3.5" - 2 Lifts)	50	Ton 19000
10	24" RC Pipe Sewer Des 3006 CL II 24" HDPE	951	L.F. 49,452
11	Connect to Existing Storm Manhole	1	Each 1500
12	Construct Drainage Structure Design 48-4020	4	Each 12,800
13	Construct Drainage Structure Design 60-4020	2	Each 9000
14	Concrete Driveway Pavement (6")	31	S.Y. 2000
15	Silt Fence	205	L.F. 615
16	Seeding (MnDOT 25-151)	0.75	Acre 500
17	Hydromulch	0.50	Acre 3000
18	Turf Reinforcement Mat Category 50	514	S.Y. 2570
Total			\$105,995

The undersigned hereby agrees that all work on the above-mentioned project shall be completed by
September 2, 2022

Note: Contractor may request substitution
of RCP Storm Sewer with HDPE.

Pearson Backhoe Service Inc.
Contractor

[Signature]
By

President
Title

Date: 4-6-22

24330 Richland Rd. St. Charles, MN 55922
Address



City of Chatfield

Thurber Community Center • Chatfield Municipal Building
21 Second Street Southeast • Chatfield, Minnesota 55923 • 507-867-3810
www.ci.chatfield.mn.us

MEMORANDUM

TO: CHATFIELD PUBLIC WORKS COMMITTEE AND CITY COUNCIL
FROM: CRAIG BRITTON
SUBJECT: 2023 STREET IMPROVEMENT PROJECT – PAY APPLICATION 2
DATE: SEPTEMBER 6, 2023
CC: CITY ADMINISTRATOR, MICHELE PETERSON
SUPERINTENDENT OF CITY SERVICES, BRIAN BURKHOLDER

Action Requested: Consideration of Pay Application #2 in the amount of \$416,606.91 to Griffin Construction for work completed on the 2023 Street Improvement Project.

Background: Griffin Construction has submitted Pay Application #2 in the amount of \$416,606.91 for work completed mainly on Prospect Street SE and Grand Street SE. Work completed includes the installation of the storm sewer on Grand Street and Prospect Street SE, the installation of the sanitary sewer on Grand Street and the placement of aggregate base on Prospect Street SE. Underground work is expected to be completed on Grand Street by September 22nd at which time Griffin will begin installing sanitary sewer on Hawley Street. Once the underground work is completed on Grand Street crews will begin street construction from 7th Avenue to Prospect. The pay application is attached to this report. Below is a quick summary of the contract amount and proposed payment.

1. Contract Amount - \$1,759,308.26
2. Pay Application 1 - \$190,034.92
3. Pay Application 2 - \$416,606.91
4. Retainage (5%) - \$21,926.68
5. Balance to Finish - \$1,120,737.91

Please let me know if you have any questions.

Sincerely,

Craig Britton

PARTIAL PAYMENT ESTIMATE

Pay Estimate 2

Name of Contractor:		
Griffin		
Name of Owner:		
City of Chatfield		
Date of Substantial Completion:	Amount of Contract:	Dates of Estimate
Original: 11/1/2023	Original: \$ 1,759,308.26	From: 08-05-23
Revised: NA	Revised: NA	To: 09-05-23

Wideth Project Number: 2022-11251

Description of Job: 2023 Street Improvement Project

ITEM NO.	ITEM DESCRIPTION	CONTRACT ITEMS				THIS PERIOD		TOTAL TO DATE	
		UNIT	QUANTITY	UNIT PRICE	AMOUNT	QUANTITY	AMOUNT	QUANTITY	AMOUNT
BID SCHEDULE A. - GRAND, PROSPECT ST SE									
1	CONTRACTOR TESTING - DENSITY	L.S.	1	\$4,550.00	\$4,550.00	0.35	\$1,592.50	0.5	\$2,275.00
2	MOBILIZATION	L.S.	1	\$68,520.00	\$68,520.00	0.5	\$34,260.00	0.75	\$51,390.00
3	CLEARING	EACH	25	\$335.00	\$8,375.00	1	\$335.00	20	\$6,700.00
4	GRUBBING	EACH	25	\$335.00	\$8,375.00	15	\$5,025.00	21	\$7,035.00
5	SALVAGE SIGN	EACH	1	\$50.00	\$50.00	0	\$0.00	1	\$50.00
6	REMOVE SIGN	EACH	11	\$50.00	\$550.00	0	\$0.00	3	\$150.00
7	REMOVE MANHOLE (SANITARY)	EACH	11	\$600.00	\$6,600.00	3	\$1,800.00	7	\$4,200.00
8	REMOVE MANHOLE (STORM)	EACH	2	\$600.00	\$1,200.00	0	\$0.00	0	
9	REMOVE CATCH BASIN	EACH	8	\$500.00	\$4,000.00	1	\$500.00	1	\$500.00
10	REMOVE GATE VALVE & BOX	EACH	7	\$300.00	\$2,100.00	3	\$900.00	3	\$900.00
11	REMOVE HYDRANT	EACH	4	\$500.00	\$2,000.00	1	\$500.00	1	\$500.00
12	REMOVE CURB & GUTTER	LIN FT	3665	\$3.00	\$10,995.00	1014	\$3,042.00	2846	\$8,538.00
13	REMOVE SEWER PIPE (STORM)	LIN FT	626	\$15.00	\$9,390.00	0	\$0.00	0	
14	REMOVE SEWER PIPE (SANITARY)	LIN FT	1976	\$6.00	\$11,856.00	619	\$3,714.00	1345.4	\$8,072.40
15	REMOVE PIPE CULVERT	LIN FT	32	\$15.00	\$480.00	40	\$600.00	40	\$600.00
16	SALVAGE RETAINING WALL	LIN FT	39	\$25.00	\$975.00	0	\$0.00	39	\$975.00
17	SAWING CONCRETE PAVEMENT (FULL DEPTH)	LIN FT	434	\$4.65	\$2,018.10	0	\$0.00	285	\$1,325.25
18	SAWING BIT PAVEMENT (FULL DEPTH)	LIN FT	363	\$3.60	\$1,306.80	0	\$0.00	163	\$586.80
19	REMOVE CONCRETE FLUME	SQ YD	21	\$12.50	\$262.50	20	\$250.00	20	\$250.00
20	REMOVE CONCRETE DRIVEWAY PAVEMENT	SQ YD	747	\$8.00	\$5,976.00	315	\$2,520.00	673	\$5,384.00
21	REMOVE BITUMINOUS PAVEMENT	SQ YD	7353	\$2.75	\$20,220.75	0	\$0.00	2205.9	\$6,066.23
22	REMOVE BITUMINOUS DRIVEWAY PAVEMENT	SQ YD	657	\$8.00	\$5,256.00	0	\$0.00	259	\$2,072.00
23	REMOVE CONCRETE SIDEWALK	SQ FT	281	\$2.00	\$562.00	120	\$240.00	120	\$240.00
24	COMMON EXCAVATION (EV) (P)	CU YD	3324	\$15.40	\$51,189.60	1000	\$15,400.00	1000	\$15,400.00
25	COMMON EXCAVATION (SUBGRADE) (EV)	CU YD	474	\$15.40	\$7,299.60	0	\$0.00	0	
26	EXCAVATION SPECIAL (EXPLORATORY)	HOUR	24	\$125.00	\$3,000.00	4	\$500.00	5.5	\$687.50

27 GEOTEXTILE FABRIC TYPE V	SQ YD	10763	\$1.70	\$18,297.10	3892	\$6,616.40	4532	\$7,704.40
28 AGGREGATE BASE CLASS 5 MODIFIED	TON	7943	\$18.15	\$144,165.45	2377	\$43,142.55	2377	\$43,142.55
29 FULL DEPTH RECLAMATION	SQ YD	1671	\$3.64	\$6,082.44	0	\$0.00	1671	\$6,082.44
30 TYPE SP 9.5 WEARING COURSE MIX (3,C)	TON	833	\$102.69	\$85,540.77	0	\$0.00	0	
31 TYPE SP 12.5 WEARING COURSE MIX (3,C)	TON	1386	\$99.42	\$137,796.12	0	\$0.00	0	
32 GRANULAR FOUNDATION AND/OR BEDDING	TON	380	\$21.50	\$8,170.00	0	\$0.00	35	\$752.50
33 6" PERF PVC PIPE DRAIN	LIN FT	3121	\$20.33	\$63,449.93	0	\$0.00	0	
34 12" RC PIPE SEWER DESIGN 3006 CLASS V	LIN FT	210	\$66.40	\$13,944.00	99	\$6,573.60	99	\$6,573.60
35 15" RC PIPE SEWER DESIGN 3006 CLASS V	LIN FT	258	\$73.35	\$18,924.30	6	\$440.10	6	\$440.10
36 18" RC PIPE SEWER DESIGN 3006 CLASS III	LIN FT	35	\$78.55	\$2,749.25	0	\$0.00	0	
37 21" RC PIPE SEWER DESIGN 3006 CLASS III	LIN FT	27	\$87.79	\$2,370.33	0	\$0.00	0	
38 24" RC PIPE SEWER DESIGN 3006 CLASS III	LIN FT	958	\$101.82	\$97,543.56	929	\$94,590.78	929	\$94,590.78
39 27" RC PIPE SEWER DESIGN 3006 CLASS III	LIN FT	315	\$127.75	\$40,241.25	0	\$0.00	0	
40 30" RC PIPE SEWER DESIGN 3006 CLASS III	LIN FT	72	\$149.85	\$10,789.20	0	\$0.00	0	
41 MAINTENANCE OF SANITARY SEWER SERVICE	L.S.	1	\$19,750.00	\$19,750.00	0.75	\$14,812.50	0.9	\$17,775.00
42 CONNECT TO EXISTING SANITARY SEWER	EACH	3	\$500.00	\$1,500.00	1	\$500.00	3	\$1,500.00
43 CONNECT TO EXISTING STORM SEWER	EACH	1	\$750.00	\$750.00	2	\$1,500.00	2	\$1,500.00
44 CONNECT TO EXISTING MANHOLES	EACH	4	\$1,000.00	\$4,000.00	0	\$0.00	0	
45 SANITARY SEWER SERVICE (4" PVC)	EACH	27	\$1,690.00	\$45,630.00	4	\$6,760.00	11	\$18,590.00
46 SANITARY SEWER SERVICE (6" PVC)	EACH	1	\$1,860.00	\$1,860.00	0	\$0.00	0	
47 8" X 4" PVC WYE	EACH	27	\$402.00	\$10,854.00	10	\$4,020.00	20	\$8,040.00
48 8" X 6" PVC WYE	EACH	1	\$472.00	\$472.00	3	\$1,416.00	3	\$1,416.00
49 SANITARY SEWER INSPECTION	LIN FT	1975	\$3.00	\$5,925.00	0	\$0.00	0	
50 8" PVC PIPE SEWER	LIN FT	1975	\$57.14	\$112,851.50	619	\$35,369.66	1392.9	\$79,590.31
51 INSTALL WATER SERVICE SYSTEM (1")	EACH	27	\$2,345.00	\$63,315.00	6	\$14,070.00	11	\$25,795.00
52 INSTALL WATER SERVICE SYSTEM (2")	EACH	1	\$4,930.00	\$4,930.00	1	\$4,930.00	1	\$4,930.00
53 CONNECT TO EXISTING WATER MAIN	EACH	4	\$1,500.00	\$6,000.00	1	\$1,500.00	3	\$4,500.00
54 HYDRANT	EACH	4	\$7,097.00	\$28,388.00	1	\$7,097.00	1	\$7,097.00
55 ADJUST VALVE BOX	EACH	11	\$275.00	\$3,025.00	0	\$0.00	0	
56 6" GATE VALVE & BOX	EACH	5	\$2,935.00	\$14,675.00	1	\$2,935.00	1	\$2,935.00
57 8" GATE VALVE & BOX	EACH	11	\$3,735.00	\$41,085.00	4	\$14,940.00	6	\$22,410.00
58 6" PVC WATER MAIN	LIN FT	98	\$49.75	\$4,875.50	21	\$1,044.75	21	\$1,044.75
59 8" PVC WATER MAIN	LIN FT	2288	\$56.50	\$129,272.00	496.5	\$28,052.25	776.5	\$43,872.25
60 DUCTILE IRON FITTINGS	POUND	1213	\$16.50	\$20,014.50	570	\$9,405.00	1088	\$17,952.00
61 CONSTRUCT DRAINAGE STRUCTURE DESIGN SPECIAL	EACH	12	\$2,900.00	\$34,800.00	6	\$17,400.00	6	\$17,400.00
62 CONSTRUCT DRAINAGE STRUCTURE DESIGN 48-4020	EACH	11	\$3,515.00	\$38,665.00	7	\$24,605.00	7	\$24,605.00
63 CONSTRUCT DRAINAGE STRUCTURE DESIGN 60-4020	EACH	4	\$5,068.00	\$20,272.00	2	\$10,136.00	2	\$10,136.00
64 CONSTRUCT DRAINAGE STRUCTURE DESIGN 72-4020	EACH	3	\$5,795.00	\$17,385.00	1	\$5,795.00	1	\$5,795.00
65 ADJUST FRAME AND RING CASTING	EACH	21	\$575.00	\$12,075.00	0	\$0.00	0	
66 CONSTRUCT SANITARY MANHOLE	EACH	9	\$3,547.00	\$31,923.00	2	\$7,094.00	7	\$24,829.00

67 CONSTRUCT SANITARY MANHOLE (LF)	LIN FT	32.86	\$300.00	\$9,858.00	3.74	\$1,122.00	24.04	\$7,212.00
68 4" CONCRETE WALK	SQ FT	214	\$12.50	\$2,675.00	0	\$0.00	0	
69 CURB AND GUTTER DESIGN B624	LIN FT	3839	\$22.40	\$85,993.60	0	\$0.00	0	
70 CURB AND GUTTER DESIGN B624 (MOD.)	LIN FT	5	\$50.00	\$250.00	0	\$0.00	0	
71 6" CONCRETE DRIVEWAY PAVEMENT	SQ YD	894	\$72.00	\$64,368.00	0	\$0.00	0	
72 TRUNCATED DOMES	SQ FT	10	\$57.00	\$570.00	0	\$0.00	0	
73 TRAFFIC CONTROL	L.S.	1	\$4,950.00	\$4,950.00	0.25	\$1,237.50	0.75	\$3,712.50
74 INSTALL SIGN TYPE C (INCLUDE SIGN POST)	EACH	3	\$375.00	\$1,125.00	0	\$0.00	0	
75 FURNISH TYPE C SIGN	EACH	3	\$150.00	\$450.00	0	\$0.00	0	
76 FURNISH TYPE D SIGN (STREET NAME SIGNS)	EACH	16	\$115.00	\$1,840.00	0	\$0.00	0	
77 INSTALL SALVAGED SIGN	EACH	1	\$250.00	\$250.00	0	\$0.00	0	
78 EROSION CONTROL SUPERVISOR	L.S.	1	\$500.00	\$500.00	0.5	\$250.00	0.5	\$250.00
79 STORM DRAIN INLET PROTECTION	EACH	21	\$250.00	\$5,250.00	0	\$0.00	10	\$2,500.00
80 SILT FENCE, TYPE MS	LIN FT	871	\$2.10	\$1,829.10	0	\$0.00	0	
81 COMMON TOPSOIL BORROW (LV)	CU YD	598	\$25.00	\$14,950.00	0	\$0.00	0	
82 STABILIZED CONSTRUCTION EXIT	L.S.	1	\$1,500.00	\$1,500.00	0	\$0.00	0	
83 SEEDING	ACRE	1.14	\$1,003.52	\$1,144.01	0	\$0.00	0	
84 FERTILIZER TYPE 3	POUND	342	\$1.00	\$342.00	0	\$0.00	0	

TOTALS =			\$ 1,759,308.26	\$ 438,533.59	\$ 638,570.35
-----------------	--	--	-----------------	---------------	---------------

AMOUNT EARNED			THIS PERIOD \$ 438,533.59	TOTAL TO DATE \$ 638,570.35
---------------	--	--	------------------------------	--------------------------------

AMOUNT RETAINED	5%		\$ 21,926.68	\$ 31,928.52
-----------------	----	--	--------------	--------------

PREVIOUS PAYMENTS			\$ -	\$ 190,034.92
-------------------	--	--	------	---------------

AMOUNT DUE			\$ 416,606.91	\$ 416,606.91
-------------------	--	--	---------------	---------------

Estimated Percentage of Job Completed:	36%
Contractor's Construction Progress:	On Schedule

CONTRACTOR'S CERTIFICATION:

The undersigned Contractor certifies that to the best of their knowledge, information and belief the work covered by this payment estimate has been completed in accordance with the contract documents, that all amounts have been paid by the Contractor for work for which previous payment estimates were issued and payments received from the Owner, and that current payment shown herein is now due.

Contractor: Griffin

By: _____

Date: _____

APPROVED BY OWNER:**Owner: City of Chatfield**

By: _____

Date: _____

ENGINEER'S CERTIFICATION:

The undersigned certifies that the work has been carefully inspected and to the best of their knowledge and belief, the quantities shown in this estimate are correct and the work has been performed in accordance with the contract documents.

Engineer:

By: _____

Date: _____



City of Chatfield

Thurber Community Center • Chatfield Municipal Building
21 Second Street Southeast • Chatfield, Minnesota 55923 • 507-867-3810
www.ci.chatfield.mn.us

MEMORANDUM

TO: CHATFIELD PUBLIC WORKS COMMITTEE
FROM: CRAIG BRITTON
SUBJECT: ENTERPRISE DRIVE BERM UPDATE
DATE: SEPTEMBER 7, 2023
CC: CITY ADMINISTRATOR, MICHELE PETERSON
SUPERINTENDENT OF CITY SERVICES, BRIAN BURKHOLDER

Action Requested: No action being requested.

Background: At the August 28th meeting, Council approved moving forward with the construction of the berm on the north side of the commercial parcels along Enterprise Drive between Vindmoll Drive SE and Hillside Drive SE. The proposed berm is planned to start at the north property line, will extend up at a 4:1 slope, will have an approximate 3 ft top and will tie back down to the existing ground on the commercial parcels at a 4:1 slope. Our survey crew shot in the existing topography and we are in the process of preparing a grading plan for the berm. I will bring the plan to the committee meeting on Monday. After running through the existing elevations on the site it appears that the berm will be between 1.5' and 2.5' tall (measured from the existing elevation on the commercial parcels) and will tie down to the existing grade at a point approximately 25 ft into the commercial parcels, which is the rear building setback distance for the parcels.

I attached a sketch of what the berm will look like and will run through the elevations and quantities with you at the meeting.

Please let me know if you have any questions.

Sincerely,

Craig Britton

Enterprise Drive Berm



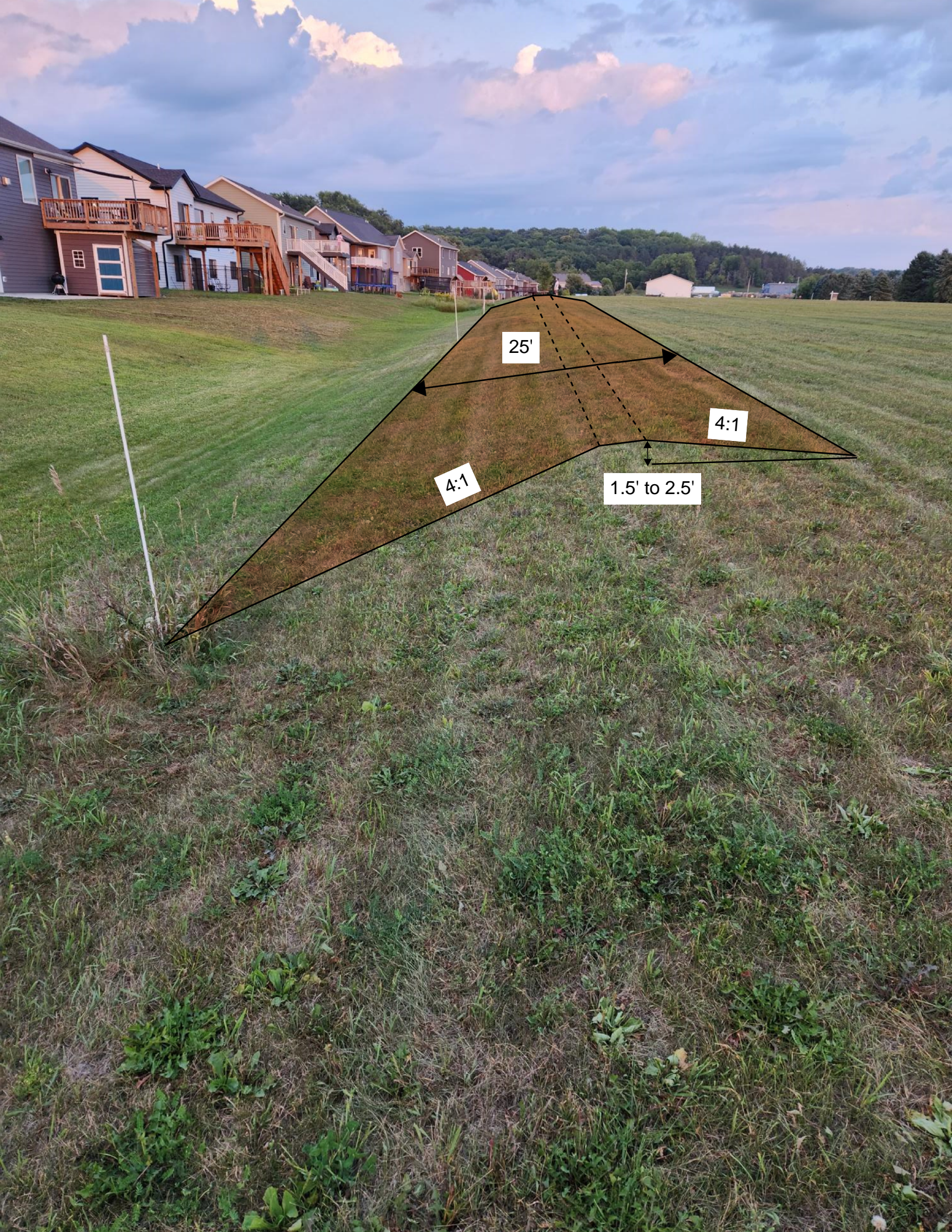

25'

4:1

4:1

1.5' to 2.5'