

Park & Recreation Committee
September 27, 2021 Agenda
5:30 p.m.

1. Park & Recreation Committee – 5:30 p.m. – September 27, 2021
2. Pool Year in review – Katie Goldsmith
3. Discuss grant award to acquire playground equipment for Lone Stone Park.
4. Discuss repairs needed at bandshell.
5. Blacktop quotes for Mill Creek Park
6. Discuss dumping at Shady Oak Park.
7. Review Bridge designs for consideration for Groen Park.

Members Present: Councilors Josh Broadwater and Pam Bluhm

Members Absent: None

Others Present: Beth Carlson, Ryan Priebe, Brian Burkholder.

Swimming Pool Closing Suggestion: Katie Goldsmith, manager of the swimming pool, has proposed to keep the pool open until August 29. Evening swim would be eliminated and adjustments to afternoon open swim and lap swim would be made. Foreseeable problems could include not enough kids coming to open swim, no pool heater, and a chlorine shortage in the country. The committee had no issues with the proposal.

Swimming Pool Pump: Ryan Priebe, Water Superintendent, is proposing to purchase an extra circulation pump for the pool. Two pumps are needed to keep the pool running. If one goes down, the pool must close. Having one on hand as a replacement can save days, if not weeks, of down time. This recommendation will move forward to council.

Swimming Pool Heater: Priebe has received two bids for a new pool heater. The recommendation is to go with the bid from Southeast Mechanical.

Dumping at Shady Oak Park: Since the no dumping signs have been put into place, Brian Burkholder, Superintendent of City Services, has had non-camping people asking where they can dump. Without having a clear answer for them, he is looking for

Mill Creek Park in need of repairs: Repairs are needed at Mill Creek Park. The main issue is a new roof is needed on the warming house. Other items include a new door and frame on the warming house plus a new coat of paint. Minor repairs to the ice rink itself and the bleacher canopy needs a new roof. There have been issues with vandalism in the past few years at the warming house so it has been suggested that a camera system for monitoring is in order before money is put into a building that has been damaged.

KUBB Tournament at Mill Creek Park October 23: PawPrint Brewery would like to sponsor a KIBB tournament in Mill Creek Park on October 23. The committee has no problems with the plans.

Lone Stone Park Grant Award to Acquire Playground Equipment: Hold off until next meeting.

The bridge at Groen Park: Hold off until next meeting.

Chatfield Aquatic Center

Wrap-Up 2021

All in all, I thought the summer went well. We had few complaints that I am aware of. Some were things that we simply can't control (cost of entry) and some we can (putting garbage in correct bins by school). The employees were receptive of my feedback and I felt like we had a good working relationship.

I liked having concession stand workers separate from guards. I think it was easier to figure out roles and responsibilities then. I would like to continue this, as well as have a front desk employee who is not a guard.

The hard part for me was getting my concession stand trips to Sam's Club figured out so I didn't make a special trip for the pool (I tried to only go when I was going for my family grocery shopping). Once the concession workers and I figured out a routine, it went much better!

We had many compliments throughout the summer. I tried to communicate those to the guards so they knew how happy some people were.

I liked that we were able to stay open longer. We had a lot of out-of-town visitors and also the Cross Country, Volleyball, and Football teams able to use the facility for their training.

Chatfield Aquatic Center

Suggestions for 2022

Open first day of summer vacation (this means training with Rocky may have to be done in the evenings and/or weekend to get employees ready; WSI would have to be moved to earlier date)

Fun day the last week of school for elementary students to come (I have already received a grant for \$500 to help with costs. Will look for more so that busing and guards can be paid for)

Registration night (for people to get their memberships registered, swim lessons scheduled, etc)

Tickets option (St. Charles does this and I can get info from their Park & Rec dept. But another way to pay for your visit; cheaper than a membership but less than several days of attending at regular fee)

Swimming Lessons

- Less lessons offered (class sizes end up too small)
- Change length of lessons to 30 minutes
- Raise price of private lessons
- Raise price of water aerobics
- Less kids in levels 1-3 (kids focus better)
- Less parent/toddler sessions & eliminate the Sunday piece (can have more private parties then) (run much like a class session of 3 Saturdays or something similar)

Raise price of nachos (They are highly loved)

Increase salaries

- Guards start at \$12; move up for WSI, up for Head Guard (max of \$15/hour) (Starting off at \$10 is lower than some other jobs in town that require way less responsibility; St. Charles goes by this pay scale, Plainview is similar)
- Other employees go up \$0.50 for each year they work at the pool

Create policy for days of few patrons (How many do we need to open? Do we stay an hour hoping for more kids to come? Do I send home guards and keep pool open?)

Finnegan Playground Adventures

1609 County Road 42 #317
Burnsville, MN 55306
952-457-2950
matt@fpacompany.com

Quote

Date	Estimate #
8/31/2021	21

Name / Address
City of Chatfield 21 SE Second Street Chatfield MN 55923 Joel Young JYoung@ci.chatfield.mn.us, MN 55923

		Terms	Project
Description	Qty	Rate	Total
R35 Custom Play System with Bucket Spinner and Neutron Spinner. Also 2 benches and ADA ramp with border timbers. Engineered woodfiber	1	46,719.00	46,719.00
	150	19.50	0.00 2,925.00
FPA COOP DISCOUNT		-7,466.00	-7,466.00
Installation of equipment and timber boarders		10,590.00	10,590.00
Freight for equipment and woodfiber delv. to the site		3,321.00	3,321.00
		Total	\$56,089.00

Tax Exempt: # _____ * Please provide certificate NOTE: Does not include concrete base. Does not include prevailing wages. PO to be made out to Finnegan Playground Adventures
UNLESS OTHERWISE NOTED, prices shown are material only. They DO NOT include: assembly, installation, border, safety surfacing, drain tile, geotextile fabric, removal of existing equipment, site preparation, excavation or site restoration, unloading of equipment, disposal of packaging material, storage of equipment, additional insurance and bonding would be extra, unless otherwise stated above. If playground equipment or materials are stored off site. Prices firm for 20 days, subject to review thereafter. Our terms 50% with order net 15 install unless discussed with prior arrangements

Customer Signature _____



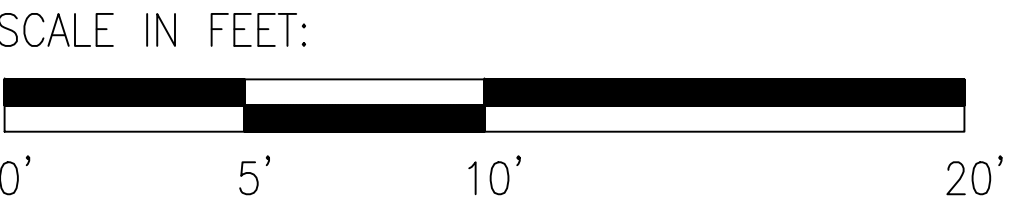

NOTE:
THE TUFFTIMBER ACCESS WEDGE WHEN
USED BY ITSELF AND PLACED ON TOP OF
THE ACCESSIBLE PATH DOES NOT CONFORM
TO THE ADA RISE/SLOPE REQUIREMENTS.
THE LOWER/LEADING EDGE MUST BE BURIED
OR COVERED WITH THE ACCESSIBLE ROUTE
MATERIAL TO COMPLY.

182503
WELCOME SIGN
(LSI PROVIDED)
5-12 YEARS

PlaySense®
(5-12 years)

130799
TUFFTIMBER
ACCESS RAMP

182503
WELCOME SIGN
(LSI PROVIDED)
2-5 YEARS

56

CONTAINER DETAILS	
TOTAL AREA	2,616 SF
TOTAL PERIMETER	200 LF
EDGING TYPE	APS BORDER

2-5 AREA

TOTAL ELEVATED PLAY COMPONENTS	5	
TOTAL ELEVATED COMPONENTS ACCESSIBLE BY RAMP	0	REQUIRED 0
TOTAL ELEVATED COMPONENTS ACCESSIBLE BY TRANSFER	5	REQUIRED 3
TOTAL ACCESSIBLE GROUND LEVEL COMPONENTS SHOWN	2	REQUIRED 2
TOTAL DIFFERENT TYPES OF GROUND LEVEL COMPONENTS	2	REQUIRED 2

5-12 AREA

TOTAL ELEVATED PLAY COMPONENTS	10	
TOTAL ELEVATED COMPONENTS ACCESSIBLE BY RAMP	0	REQUIRED 0
TOTAL ELEVATED COMPONENTS ACCESSIBLE BY TRANSFER	5	REQUIRED 5
TOTAL ACCESSIBLE GROUND LEVEL COMPONENTS SHOWN	3	REQUIRED 3
TOTAL DIFFERENT TYPES OF GROUND LEVEL COMPONENTS	3	REQUIRED 3



FLAGSHIP RECREATION
11123 UPPER 33RD ST N
LAKE ELMO, MN 55082
763-550-7860
FLAGSHIPPLAY.COM
@FLAGSHIPPLAY



THIS PLAY AREA & PLAY EQUIPMENT
IS DESIGNED FOR AGE RANGES AS
NOTED ON PLAN.

LONESTONE PARK
PLAYGROUND
OPTION 2

LONESTONE COURT
CHATFIELD, MN 55923

SALES
REPRESENTATIVE:
BRADY PATE

DESIGNED BY:
ELM
3/24/20

G:\My Drive\2020 Planning\Brady\Brady_Chathfield_Lone Stone Park\Design
(Lonestone Park)\LonestonePark_OPT 2\Chatfield_LoneStonePark -OPT2.dwg

11

SHEET

LS101

State Contract Pricing



PROJECT INFORMATION

Project name	<u>Lonestone Park OPT 1</u>
Address	<u>21 SE Second Street</u>
City, State ZIP	<u>Chatfield, MN 55923</u>
Contract Year	<u>2021</u>

EQUIPMENT INFORMATION & PRICING

<u>Qty</u>	<u>Item No.</u>	<u>Description</u>	<u>Price</u>	<u>Ext Price</u>
1	176124A	PlaySense Design 30 DB Only	\$9,090.00	\$9,090.00
1	164074B	Single Bobble Rider DB	\$1,268.00	\$1,268.00
1	152179A	Saddle Spinner DB 12"Height	\$1,081.00	\$1,081.00
1	176142A	PlaySense Design 301 DB Only	\$20,776.00	\$20,776.00
1	182503C	Welcome Sign (LSI Provided) Ages 5-12 years Direct Bury	\$0.00	\$0.00
Total Equipment Cost at State Contract Pricing				\$32,215.00



Brian Burkholder
21 SE Second Street
Chatfield, MN 55923
Brian Burkholder

8/30/2021

PRELIMINARY BUDGET

	Preliminary Budget	Possible Additions	Possible Reductions	QTY	Notes
Play Equipment & Installation					
Design - Lone Stone Park OPT 2	32,215.00				List Price of Equipment
State Contract Discount	(1,932.90)			6%	State Contract #119795
Sales Tax - if applicable	0.00				
Equipment Installation (Man Hours & Concrete for Footings)	8,788.16				Full professional installation by Landscape Structures Certified Installers
Delivery of Play equipment	400.00				estimated / final quote will be provided
Per Diem	500.00				estimated / final quote will be provided
Mobilization	500.00				
Dumpster(s) - 30 Yard	525.00		-525.00		Disposal of packaging material *Possible deduction if City can dispose of material.
Site work					
Excavation & Hauling (new container)	0.00				
Demo, Excavation & Disposal (existing container)	0.00				
Border Options					
Plastic Timbers & Ramp	2,697.81				
Subgrade Preparation					
Drainage Aggregate - Pea Rock (Tons)	1,227.93			31	Pea Rock - 3" depth - Recommended with EWF installations
Surfacing Engineered Wood Fiber (EWF)					
EWF - Playground Safety Surfacing (CY)	3,523.78			87	IPEMA Certified Playground Surfacing - Meets the standards of ASTM, ADA & CPSC
GeoTextile Fabric (Sq. Ft.)	0.00			0	Price includes installation
Site Restoration (Sq.Ft.)					
	0.00			0	Top soil, seed and blanket
	Budget Total	Total Additions	Total Reductions		Total w/ Additions & Reductions
	48,444.78	0.00	-525.00		47,919.78

St. Croix Recreation Fun Playgrounds INC.

1826 Tower Dr W
Stillwater, MN 55082 US
16514301247
hannah@stcroixrec.com



Estimate

ESTIMATE # 4253**DATE** 09/02/2021**EXPIRATION DATE** 11/15/2021**ADDRESS**

City of Chatfield
21 SE 2nd St
Chatfield, MN 55923

SHIP TO

City of Chatfield
Attn: Brian Burkholder
21 SE 2nd St
Chatfield, MN 55923

PLEASE DETACH TOP PORTION AND RETURN WITH YOUR PAYMENT.

SHIP VIA

Best

SALES REP

JWJ

ACTIVITY	QTY	RATE	AMOUNT
BCI CUSTOM 5-12 Year Old Structure	1	32,644.00	32,644.00T
BCI 560-2586 Comet I	1	1,936.00	1,936.00T
BCI 046-0053 6ft STONEBORDER/2 DRIVE PINS	24	76.00	1,824.00T
BCI 046-0055 END CAP	2	65.00	130.00T
BCI 580-0172 6' PVC TRADITIONAL BENCH W/BACK, STATIONARY	1	571.00	571.00T
RESILIENT RESILIENT SURFACING ENGINEERED WOOD	75	28.33333333	2,125.00T
INSTALL INSTALLATION OF EQUIPMENT BY OTHERS	1	8,760.00	8,760.00
STATE CONTRACT STATE CONTRACT #119803	40,123	-0.04	-1,604.92T
Freight	1	1,725.00	1,725.00T
BCI 046-0153 BORDER RAMP W/STAKES	1	1,149.00	1,149.00T

QUOTES ARE EFFECTIVE FOR 30 DAYS.

SALES TAX SUBJECT TO CHANGE. ADD IF NOT EXEMPT OR SUPPLY
EXEMPTION CERTIFICATE IF NOT ON FILE (ANNUALLY).

PAYMENT TERMS ARE NET 30 DAYS UNLESS OTHERWISE NOTED.

FAILURE TO PAY IN A TIMELY MANNER MAY INCUR INTEREST.

SUBTOTAL

49,259.08

TAX (0%)

0.00

TOTAL**\$49,259.08**

Accepted By

Accepted Date

By signing estimate or authorizing by email or PO, purchaser is agreeing to all terms and conditions as listed on the estimate, body of emails and supplemental documents including billing terms, shipping information and model number(s), quantity and color(s).

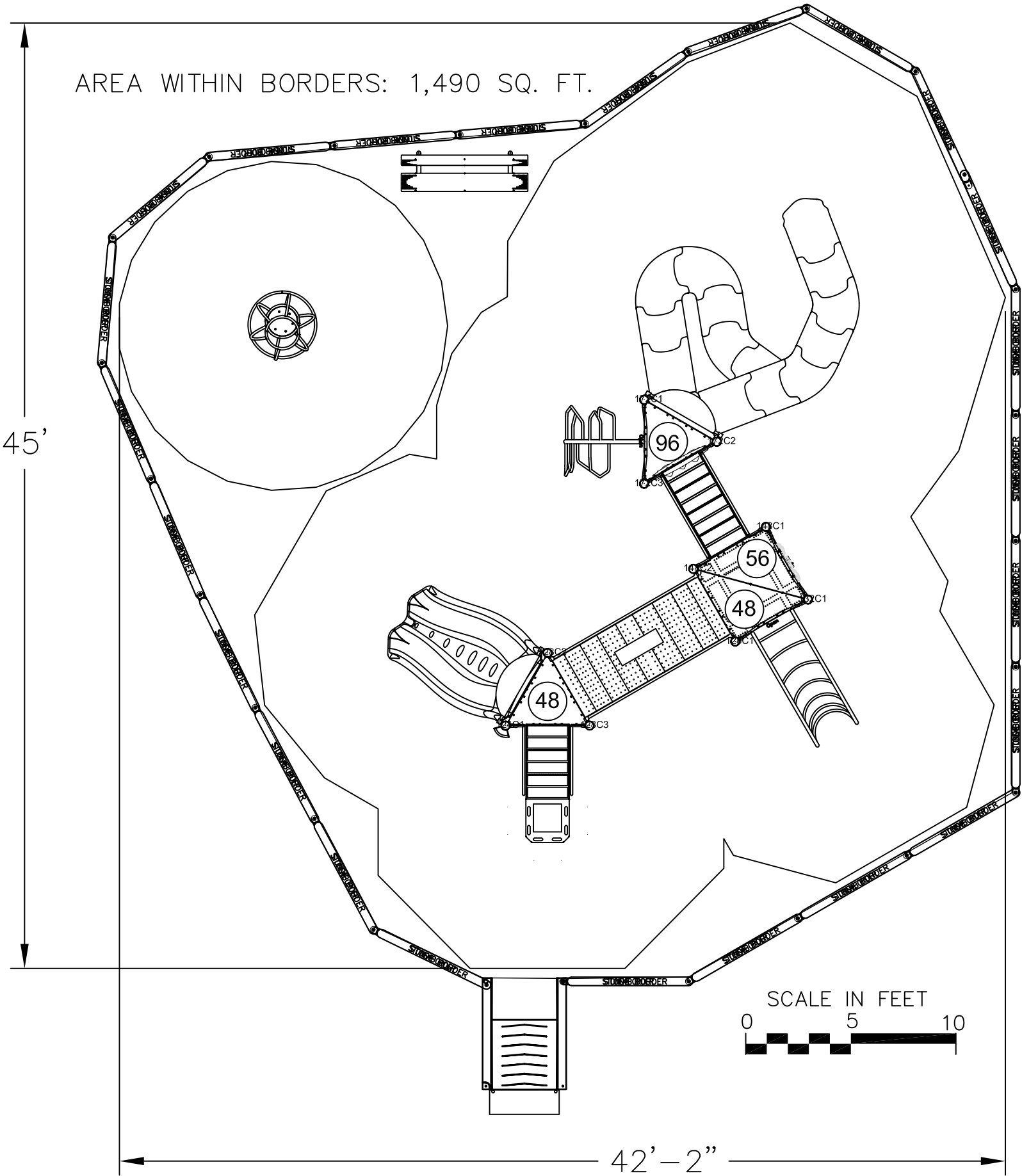

Burke.

SERIES Basics, Nucleus
SITE PLAN

DRAWN BY: Kari Champeau

BCI Burke Company, LLC PO Box 549 Fond du Lac, Wisconsin 54936-0549 Telephone 920-921-9220

Lonestone Park
Lonestone Development
Chatfield, MN 55923

St. Croix Recreation Fun Playgrounds In-
100-127872-4

September 02, 2021

Chatfield Parks Department Lonestone Park

Proposal # 100-127872-4
September 02, 2021

Presented by
St. Croix Recreation Fun Playgrounds Inc.

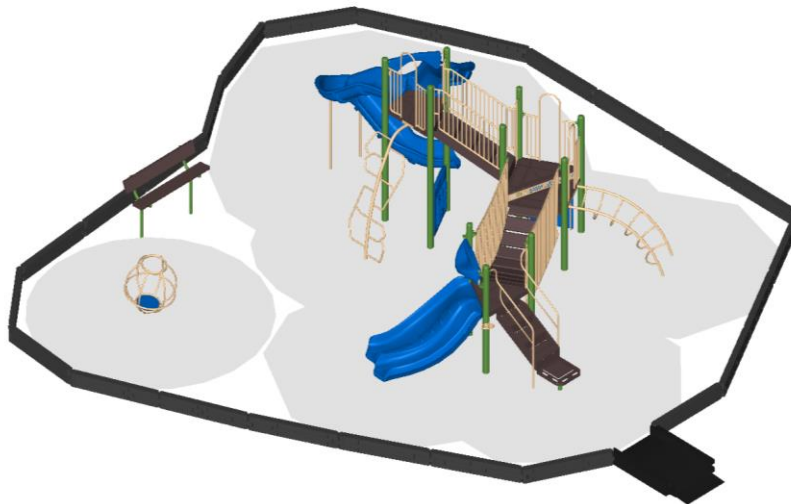

Burke®



September 02, 2021

Brian Burkholder
Chatfield Parks Department
21 SE 2nd Street
Chatfield, MN 55923

Dear Brian Burkholder:

St. Croix Recreation Fun Playgrounds Inc. is delighted to provide Chatfield Parks Department with this playground equipment proposal.

This design was developed with your specific needs in mind, and we look forward to discussing this project further with you to ensure your complete satisfaction. St. Croix Recreation Fun Playgrounds Inc. is confident that this proposal will satisfy Chatfield Parks Department's functional, environmental, and safety requirements -- and most importantly -- bring joy and excitement to the children and families directly benefiting from your new playground.

You have our personal commitment to support this project and your organization in every manner possible, and we look forward to continue developing a long-standing relationship with Chatfield Parks Department. We appreciate your consideration and value this opportunity to earn your business.

Sincerely,

Johnnie Johnsen
St. Croix Recreation Fun Playgrounds Inc.
1826 Tower Dr W
Stillwater, MN 55082

Design Summary

St. Croix Recreation Fun Playgrounds Inc. is very pleased to present this Proposal for consideration for the Lonestone Park located in Chatfield. BCI Burke Company, LLC has been providing recreational playground equipment for over 90 years and has developed the right mix of world-class capabilities to meet the initial and continuing needs of Chatfield Parks Department. We believe our proposal will meet or exceed your project's requirements and will deliver the greatest value to you.

The following is a summary of some of the key elements of our Proposal:

- Project Name: Lonestone Park
- Project Number: 100-127872-4
- User Capacity: 61
- Age Groups: Ages 5-12 years
- Dimensions: 45' 0" x 42' 2"
- Designer Name: Kari Champeau

St. Croix Recreation Fun Playgrounds Inc. has developed a custom playground configuration based on the requirements as they have been presented for the Lonestone Park playground project. Our custom design will provide a safe and affordable playground environment that is aesthetically pleasing, full of fun for all users and uniquely satisfies your specific requirements. In addition, proposal # 100-127872-4 has been designed with a focus on safety, and is fully compliant with ASTM F1487 and CPSC playground safety standards.

We invite you to review this proposal for the Lonestone Park playground project and to contact us with any questions that you may have.

Thank you in advance for giving us the opportunity to make this project a success.

INFORMATION
MINIMUM FALL ZONE
SURFACED WITH
RESILIENT MATERIAL
AREA

1253 SQ. FT.

PERIMETER

185 FT.

STRUCTURE SIZE

45' 0" x 42' 2"

STRUCTURE IS DESIGNED
FOR CHILDREN AGES:

- ☐ 6-23 MONTH OLDS
☐ 2-5 YEAR OLDS
☒ 5-12 YEAR OLDS
☐ 13 + YEAR OLDS



Registered
to ISO 9001



To verify product certification,
visit www.ipema.org

The play components identified
in this plan are IPEMA
certified. The use and layout of
these components conform to the
requirements of ASTM F1487.
To verify product certification,
visit www.ipema.org

The space requirements shown
here are to ASTM standards.
Requirements for other standards
may be different.

The use and layout of play
components identified in this plan
conform to the CPSC guidelines.
U.S. CPSC recommends the
separation of age groups in
playground layouts.

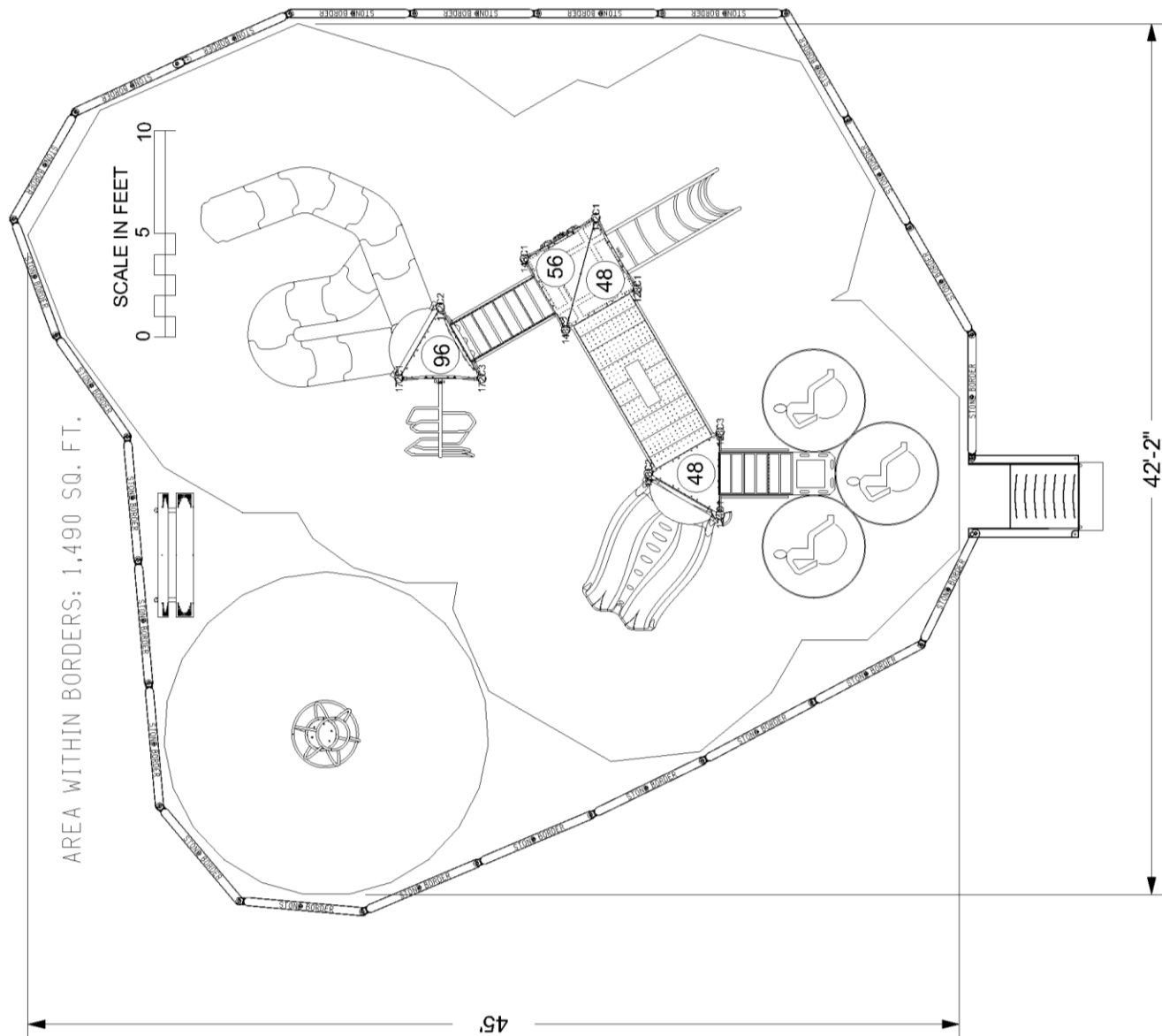

WARNING!

ACCESSIBLE SAFETY SURFACING MATERIAL IS REQUIRED BENEATH
AND AROUND THIS EQUIPMENT.
FOR SLIDE FALL ZONE SURFACING AREA SEE CPSC's Handbook for
Public Playground Safety.
PLATFORM HEIGHTS ARE IN INCHES ABOVE RESILIENT MATERIAL.

ADA ACCESSIBILITY GUIDELINE (ADAAG CONFORMANCE)

NUMBER OF PLAY EVENTS:	9
NUMBER OF ELEVATED PLAY EVENTS:	6
NUMBER OF ELEVATED PLAY EVENTS ACCESSIBLE BY RAMP:	PROVIDED: 0
NUMBER OF ELEVATED PLAY EVENTS ACCESSIBLE BY TRANSFER SYSTEM:	PROVIDED: 6
NUMBER OF ELEVATED PLAY EVENTS ACCESSIBLE BY RAMP OR TRANSFER SYSTEM:	PROVIDED: 3
NUMBER OF GROUND LEVEL PLAY EVENTS:	PROVIDED: 3
NUMBER OF TYPES OF GROUND LEVEL PLAY EVENTS:	REQD: 2

Burke

September 02, 2021

SERIES: Basics, Nucleus

SITE PLAN

DRAWN BY: Kari Champeau

Lonestone Park

Lonestone Development

Chatfield, MN 55923

St. Croix Recreation Fun Playgrounds Inc.

100-127872-4

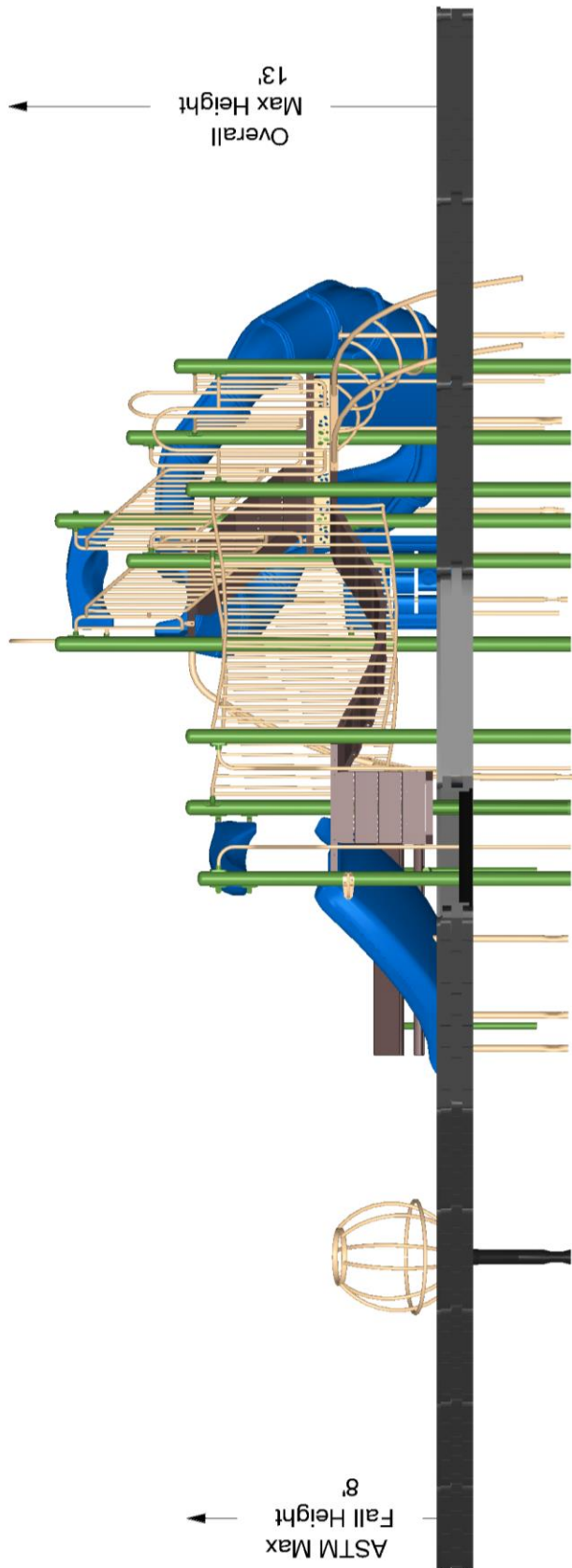

The protective surfacing for this design must accommodate the critical fall height.

Burke

September 02, 2021

SERIES: Basics, Nucleus

ELEVATION PLAN

DRAWN BY: Kari Champeau

Lonestone Park
Lonestone Development
Chatfield, MN 55923

St. Croix Recreation Fun Playgrounds Inc.

100-127872-4

BCI Burke Company, LLC PO Box 549 Fond du Lac, Wisconsin 54936-0549 Telephone 920-921-9220

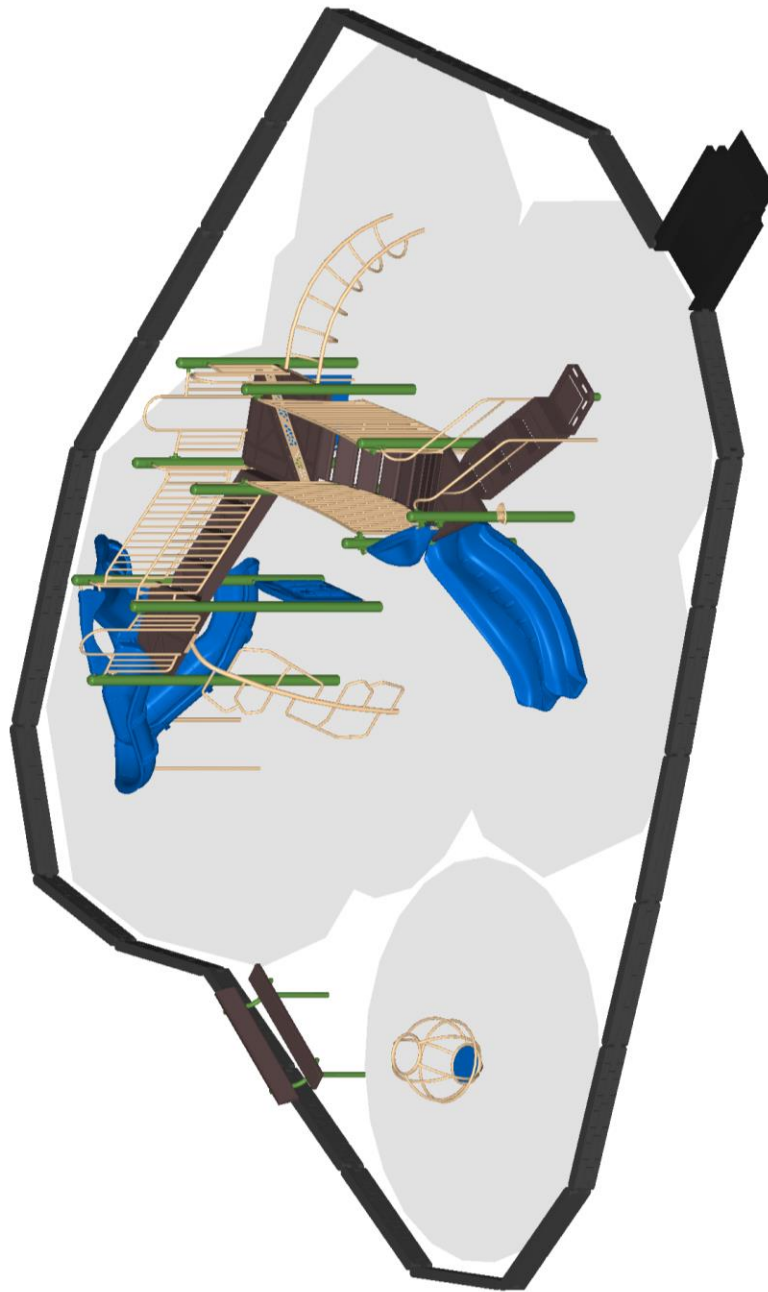

Burke

September 02, 2021

SERIES: Basics, Nucleus

ISOMETRIC PLAN

DRAWN BY: Kari Champeau

Lonestone Park
Lonestone Development
Chatfield, MN 55923

St. Croix Recreation Fun Playgrounds Inc.

100-127872-4

BCI Burke Company, LLC PO Box 549 Fond du Lac, Wisconsin 54936-0549 Telephone 920-921-9220



Proposal # 100-127872-4

September 02, 2021

2021 (Aug) Pricing

Proposal Prepared for:

Brian Burkholder
Playgrounds Inc.
Chatfield Parks Department
21 SE 2nd Street
Chatfield, MN 55923
Phone: 507-867-1511

Project Location:

Lonestone Park

Lonestone Development
Chatfield, MN 55923

Proposal Prepared by:

St. Croix Recreation Fun

1826 Tower Dr W
Stillwater, MN 55082
Phone: 651-430-1247
Fax: 651-430-9231
jj@stcroixrec.com

Johnnie Johnsen
Phone: 651-430-1247
Fax: 651-430-9231
jj@stcroixrec.com

Component No.	Description	Qty	User Cap	Ext. User Cap	Weight	Ext. Weight
Phase One						
Nucleus						
072-0500-124C	5" OD X 124" CAPPED POST	1	0	0	65	65
072-0500-128C	5" OD X 128" CAPPED POST	3	0	0	67	201
072-0500-132C	5" OD X 132" CAPPED POST	1	0	0	69	69
072-0500-148C	5" OD X 148" CAPPED POST	2	0	0	78	156
072-0500-172C	5" OD X 172" CAPPED POST	3	0	0	90	270
270-0112	UNITARY ENCLOSURE	3	0	0	34	102
270-0129	TRIANGLE PLATFORM	2	2	4	48	96
270-0189	LONG BUCKLE BRIDGE W/BARRIERS	1	10	10	469	469
270-0301	SPLIT SQUARE PLATFORMCLOSURE ...	1	4	4	108	108
370-0045	LOOP CLIMBER 32" - 48"	1	2	2	79	79
370-0108	STEEP PEAK CLIMBER 56"	1	2	2	74	74
370-0469	40" TRANSITION STAIR W/BARRIE...	1	4	4	279	279
370-1623	CRUNCH BAR STATION	1	1	1	4	4
370-1642	VERVE CLIMBER 96" DK	1	6	6	67	67
370-1659	TRANSFER STATION, HANDRAIL 48"	1	6	6	210	210
470-0574	VIPER II OVER UNDER 96	1	8	8	479	479
470-0755	LUGE SLIDE, 48"-56"	1	4	4	198	198
570-0784	TIC TAC TOE PANEL ASSEMBLY, GL	1	4	4	58	58
600-0104	NPPS SUPERVISION SAFETY KIT	1	0	0	3	3
660-0103	MAINTENANCE KIT, STRUCTURE	1	0	0	7	7
660-0104	INSTALLATION KIT, STRUCTURE	1	0	0	5	5

Phase One User Capacity: 55
Phase One Weight: 2,998 lbs.
Phase One Price: \$32,644

Phase Two

6' Stone Borders

046-0053	6ft STONEBORDER/2 DRIVE PINS	24	0	0	32	768
046-0153	BORDER RAMP W/STAKES	1	0	0	167	167

Burke Basics

560-2586	COMET I	1	6	6	154	154
----------	---------	---	---	---	-----	-----



Proposal # 100-127872-4

September 02, 2021

2021 (Aug) Pricing

580-0172	6' PVC TRADITIONAL BENCH W/BA...	1	0	0	119	119
660-0101	INSTALL KIT, BURKE BASICS - P...	1	0	0	2	2

Phase Two User Capacity: 6
Phase Two Weight: 1,210 lbs.
Phase Two Price: \$5,479

Total User Capacity: 61
Total Weight: 4,208 lbs.
Total Price: \$38,123

Information is relative to the Sep 2 2021 4:35AM database.

Special Notes:

Prices do not include freight, unloading, material storage, site excavation/preparation, removal of existing equipment, removal of excess soil from footing holes, site security, safety surfacing, installation, or sales tax (if applicable). Prices are based on standard colors per CURRENT YEAR BCI Burke Catalog. Custom colors, where available, would be an extra charge. **Pricing is valid for 30 days from the date of this proposal.**



Proposal # 100-127872-4

September 02, 2021
2021 (Aug) Pricing

Selected Color List

<u>Color Group</u>	<u>Color</u>
<i>Phase 1</i>	
Accessory	Tan
Platform	Brown
Post	Olive
Kore Konnect	Olive
Rotomolded	Blue
1 Color Extruded/Flat	Blue
<i>Phase 2</i>	
Accessory	Tan
1 Color Extruded/Flat	Blue
Table/Bench Legs	Olive
Table/Bench	Brown

BURKE GENERATIONS WARRANTY®

The Longest and Strongest warranty in the industry

BCI Burke Company, LLC ("Burke") warrants that all standard products are warranted to be free from defects in materials and workmanship, under normal use and service, for a period of one (1) year from the date of shipment.

We stand behind our products. In addition, the following products are warranted, under normal use and service from the date of shipment as follows:

- One Hundred (100) Year Limited Warranty on aluminum and steel upright posts (including Intensity®, Synergy™, Nucleus®, Voltage®, Little Buddies®, ELEVATE®, ACTIVATE®, INVIGORATE™) against structural failure due to corrosion, deterioration or workmanship.
- One Hundred (100) Year Limited Warranty on KoreConnect® clamps against structural failure due to corrosion, deterioration or workmanship.
- One Hundred (100) Year Limited Warranty on Hardware (nuts, bolts, washers)
- One Hundred (100) Year Limited Warranty on bolt-through fastening and clamp systems (Synergy™, Intensity®, Nucleus®, Voltage®, Little Buddies®, ELEVATE®).
- Twenty-Five (25) Year Limited Warranty on spring assemblies and aluminum cast animals.
- Fifteen (15) Year Limited Warranty on structure platforms and decks, metal roofs, table tops, bench tops, railings and barriers against structural failure due to materials or workmanship.
- Fifteen (15) Year Limited Warranty on all plastic components including StoneBorders against structural failure due to materials or workmanship.
- Ten (10) Year Limited Warranty on ShadePlay Canopies fabric, threads, and cables against degradation, cracking or material breakdown resulting from ultra-violet exposure, natural deterioration or manufacturing defects. This warranty is limited to the design loads as stated in the specifications.
- Ten (10) Year Limited Warranty on NaturePlay® Boulders and GRC products against structural failure due to natural deterioration or workmanship. Natural wear, which may occur with any concrete product with age, is excluded from this warranty.
- Ten (10) Year Limited Warranty on Full Color Custom Signage against manufacturing defects that cause delamination or degradation of the sign. Full Color Custom Signs also carry a two (2) year warranty against premature fading of the print and graphics on the signs.
- Five (5) Year Limited Warranty on Intensity® and RopeVenture® cables and LEVEL X® flex bridge against premature wear due to natural deterioration or manufacturing defects. Determination of premature wear will be at the manufacturer's discretion.
- Five (5) Year Limited Warranty on moving parts, including swing components, against structural failure due to materials or workmanship.
- Five (5) Year Limited Warranty on PlayEnsemble® cables and mallets against defects in materials and workmanship.
- Three (3) Year Limited Warranty on electronic panel speakers, sound chips and circuit boards against electronic failure caused by manufacturing defects.

The warranty stated above is valid only if the equipment is erected in conformity with the layout plan and/or installation instructions furnished by BCI Burke Company, LLC using approved parts; have been maintained and inspected in accordance with BCI Burke Company, LLC instructions. Burke's liability and your exclusive remedy hereunder will be limited to repair or replacement of those parts found in Burke's reasonable judgment to be defective. Any claim made within the above stated warranty periods must be made promptly after discovery of the defect. A part is covered only for the original warranty period of the applicable part. Replacement parts carry the applicable warranty from the date of shipment of the replacement from Burke. After the expiration of the warranty period, you must pay for all parts, transportation and service charges.

Burke reserves the right to accept or reject any claim in whole or in part. Burke will not accept the return of any product without its prior written approval. Burke will assume transportation charges for shipment of the returned product if it is returned in strict compliance with Burke's written instructions.

THE FOREGOING WARRANTIES ARE EXCLUSIVE AND IN LIEU OF ANY OTHER WARRANTY, EXPRESS OR IMPLIED, INCLUDING BUT NOT LIMITED TO ANY IMPLIED WARRANTY OR MERCHANTABILITY OR FITNESS FOR A PARTICULAR PURPOSE. IF THE FOREGOING DISCLAIMER OF ADDITIONAL WARRANTIES IS NOT GIVEN FULL FORCE AND EFFECT, ANY RESULTING ADDITIONAL WARRANTY SHALL BE LIMITED IN DURATION TO THE EXPRESS WARRANTIES AND BE OTHERWISE SUBJECT TO AND LIMITED BY THE TERMS OF BURKE'S PRODUCT WARRANTY. SOME STATES DO NOT ALLOW THE EXCLUSION OF CERTAIN IMPLIED WARRANTIES, SO THE ABOVE LIMITATION MAY NOT APPLY TO YOU.

Warranty Exclusions: The above stated warranties do not cover: "cosmetic" defects, such as scratches, dents, marring, or fading; damage due to incorrect installation, vandalism, misuse, accident, wear and tear from normal use, exposure to extreme weather; immersion in salt or chlorine water, unauthorized repair or modification, abnormal use, lack of maintenance, or other cause not within Burke's control; and

Limitation of Remedies: Burke is not liable for consequential or incidental damages, including but not limited to labor costs or lost profits resulting from the use of or inability to use the products or from the products being incorporated in or becoming a component of any other product. If, after a reasonable number of repeated efforts, Burke is unable to repair or replace a defective or nonconforming product, Burke shall have the option to accept return of the product, or part thereof, if such does not substantially impair its value, and return the purchase price as the buyer's entire and exclusive remedy. Without limiting the generality of the foregoing, Burke will not be responsible for labor costs involved in the removal of products or the installation of replacement products. Some states do not allow the exclusion of incidental damages, so the above exclusion may not apply to you.

The environment near a saltwater coast can be extremely corrosive. Some corrosion and/or deterioration is considered "normal wear" in this environment. Product installed within 500 yards of a saltwater shoreline will only be covered for half the period of the standard product warranty, up to a maximum of five years, for defects caused by corrosion. Products installed in direct contact with saltwater or that are subjected to salt spray are not covered by the standard warranty for any defects caused by corrosion.

Contact your local Burke Representative for warranty information regarding Burke Turf® and Burke Tile products.

Terms of Sale

Pricing: Prices published in this catalog are in USD, are approximate and do not include shipping & handling, surfacing, installation nor applicable taxes. All prices are subject to change without notice. Contact your Burke representative for current pricing. Payments are to be made in USD.

Weights: Weights are approximate and may vary with actual orders.

Installation: All equipment is shipped unassembled. For a list of factory-certified installers in your area, please contact your Burke representative.

Specifications: Product specifications in this catalog were correct at the time of publication. However, product improvements are ongoing at Burke, and we reserve the right to change or discontinue specifications without notice.

Loss or Damage in Transit: A signed bill of lading is our receipt from a carrier that our shipment to you was complete and in good condition upon arrival. Before you sign, please check the Bill of Lading carefully when the shipment arrives to make sure nothing is missing and there are no damages. Once the shipment leaves our plant, we are no longer responsible for any damage, loss or shortage.

For more information regarding the warranty, call Customer Service at 920-921-9220 or 1-800-356-2070.

01/2021

BCIBURKE.COM

Burke

800.266.1250

Joel Young

From: Carmen Narveson <carmennarveson@gmail.com>
Sent: Wednesday, August 25, 2021 10:28 AM
To: Brian Burkholder; Joel Young
Subject: Band shell rejuvenation

Hi Joel and Brian- In my own mind I have been thinking that the band shell is in need of a renovation and maybe we should do it before it starts looking bad. Two or three people have brought it to my attention and Bill and I talked about it a bit. From my perspective it might need new shingles, some repair and replacing of wood pieces, and a new paint job. There might be more- I'm just around it a lot and don't notice as much.

I don't pretend to know the process and I know the city has to budget and get bids, but if you decide to do that, I will be happy to work on fundraising from the Foundation and the Booster club. While I don't mind the colors (and I helped pick them), someone more artistic than I might pick a good color combination that blends with the park and pick shingle color to coordinate. The band will probably get a new banner also.

I am interested in your thoughts on this. It seems that the band shell is getting used more and more and for many different purposes. Just what we intended! Please keep me in the loop. Thanks so much.

--

Carmen Narveson

INTEROFFICE MEMORANDUM

TO: Park & Recreation Committee
FROM: Brian Burkholder, SCS
SUBJECT: New blacktop/Mill Creek Park
DATE: 9/22/2021

Action Requested: To discuss and to consider either blacktopping or concrete the new gravel portions at the 2 ballfields and new walking path to the playground in Mill Creek Park.

Background: A couple weeks ago, some work was done around the new dugouts at both ballfields and a new walking path was made going to the playground. This was completed to make the playground ADA compliant and the shelter.

I received a quote for new blacktop to see the cost but will also receive a quote for concrete. Would we rather have blacktop to match the current paths or concrete that would last much longer with very little maintenance?

If we plan to go ahead with this project, I will plan to complete this next Spring/Summer.

Thank you for your consideration!
Brian Burkholder

Asphalt Armor Sealcoating & Paving LLC

30831 County Road 12

Winona, MN 55987

(507) 458-8189 mobile

(507) 454-7574 office

Proposal

DATE

9/19/2021

Web Site

www.asphalarmorsealcoating.com

E-mail

dean@hbc.com

NAME / ADDRESS

City of Chatfield
Brian Burkholder
21 2nd St. SE
Chatfield, MN 55923

ESTIMATE #

4457

ITEM	DESCRIPTION	TOTAL
Street Repair	RE: Path Playground Pave a 8' x 55' area with hot mix asphalt, 3 inches overall compacted thickness.	2,499.20
Street Repair	Re: Southfield Pave a 12' x 26' , 8' x 26', 9' x 27' and a 3' x 37' areas with hot mix asphalt, 3 inches overall compacted thickness.	4,964.32
Street Repair	Re: Northfield Pave a 12' x 41', 3' x 33', 13' x 47' and a 3' x 38' areas with hot mix asphalt, 3 inches overall compacted thickness.	7,446.48
<div>1. We would like to work in daylight hours to ensure a quality application. This proposal is not for night work or weekend work.</div> <div>2. IF PROPOSAL IS ACCEPTED, SIGN AND FORWARD ONE COPY TO OUR OFFICE</div> <div>3. This proposal may be withdrawn if not accepted and received by CONTRACTOR within 15 days.</div> <div>4. Any alterations or deviation from above specifications involving extra costs, will be an extra charge over and above the estimate.</div> <div>5. Price subject to change if asphalt and or diesel costs increase more than 10% from 9/11/21 levels or buried utility lines are located requiring a hand digging.</div> <div>6. All agreements contingent upon accidents or delays beyond our control.</div> <div>7. Payment due in full upon completion of the job.</div> <div>8. Open accounts over 30 days charged 1.5% interest per month and any recovery costs</div> <div>9. Mix designs are limited to what is being produced at Dunn Plant 66 or Math plant 6 at the time of construction unless otherwise specified.</div>		
ACCEPTANCE OF PROPOSAL		TOTAL
SIGNATURE		

SIGNATURE

Asphalt Armor Sealcoating & Paving LLC

30831 County Road 12

Winona, MN 55987

(507) 458-8189 mobile

(507) 454-7574 office

Proposal

DATE

9/19/2021

Web Site

www.asphalarmorsealcoating.com

E-mail

dean@hbc.com

NAME / ADDRESS

City of Chatfield
Brian Burkholder
21 2nd St. SE
Chatfield, MN 55923

ESTIMATE #

4457

ITEM	DESCRIPTION	TOTAL
	<p>10. A 2% slope is required for drainage.</p> <p>11. Sealcoating requires overnight low 50 (F) degrees and above. This season begins in May and end September 15. Paving in temps must be warm enough for project. After mid October we will only do small projects under 30 tons.</p> <p>12. This price will be increased if prevailing wage is required on this project,</p> <p>13. If soft areas are found there may be additional costs to fix them.</p> <p>14. Aggregate base must be firm in order to pave</p> <p>15. Not responsible for delays or disruptions do to corona virus or following governments rules related to pandemic.</p>	
ACCEPTANCE OF PROPOSAL		
SIGNATURE		TOTAL \$14,910.00

THANK YOU FOR THE OPPORTUNITY TO QUOTE YOUR WORK!

SIGNATURE

Joel Young

From: Brian Burkholder
Sent: Tuesday, August 10, 2021 1:52 PM
To: Joel Young; Mayor Smith; Russell Smith
Subject: RE: Council Member Input

Here are my thoughts on this issue...

I do believe we need to provide a service to dump campers that are not staying at our city camp sites and I feel there are 2 things that we are talking about that are taking place.

1. Campers using the city camp site and the condition of the sewer service. It has plugged up 2 times in the past 2 years. the last occurrence cost \$524. After a camera was used and then cleaned out by the contractor, the comments stated that it was plugged with paper and the line was free flowing after completed. I was also told by Steven that the 4" sewer line is off-set going to the street which could cause hang ups. Until it is repaired, it will work with those camping but not major dumps at one time.
2. To provide a service of dumping of non-site renters and in talking with Steven as well, from the (MPCA) that larger dumping other than site users' needs to be monitored and not allowed at the campsite as it can be abused with unlocked and accessible open holes. Since we have learned by campsite renters, that this has been happened more often and now have been locked and only unlocked when sites are being used by renters.

I believe the sites can be used as they have been in the past knowing that it could get plugged with the use as it is and do believe we should keep them locked to only paid users at \$15.00 a day. In talking with Steven, we believe that if a non-renter wants to dump that they call city hall or the WWTP to set up a time to dump at the WWTP Monday thru Friday 7:00 am to 3:00 pm with a \$15.00 charge. Currently that I am aware of is Preston does not have a site but Fillmore County does near the Preston plant that charges \$5.00. Stewartville does not currently have a fee because they have only been asked 1 time in the last 4 years so they allowed to dump at there WWTP in a manhole at no charge that one time. I believe a \$15.00 fee would be appropriate for Chatfield because it is a service but also they could pay the \$15.00 fee then we unlock it and either they stay or just dump and leave. A sign could be installed at Shady Oak stating a number to call, times, the location and the fee.

Brian Burkholder

Superintendent of City Service

21 SE Second Street

Chatfield, MN 55923

bburkholder@ci.chatfield.mn.us

Office 507-867-1511

Cell 507-273-9597

From: Joel Young <JYoung@ci.chatfield.mn.us>
Sent: Tuesday, August 10, 2021 8:51 AM
To: Mayor Smith <mayorsmith@ci.chatfield.mn.us>; Russell Smith <russell.m.smith@state.mn.us>
Cc: Brian Burkholder <bburkholder@ci.chatfield.mn.us>
Subject: FW: Council Member Input

Please review the thread below, input from a resident.

Joel